

Cavity construction joinery installation - critical requirements

The Cavity Construction joinery installation process provided as an Acceptable Solution in Building Code Clause E2/AS1 (External Moisture) Amendment 7 has several critical requirements – some of which are illustrated below. Please refer to the Acceptable Solution for full details. The current WANZ Guide to Window Installation also describes all the steps in detail and will help to prevent issues. Available from the WANZ website.

1

Select a WANZ sill support bar appropriate for the weight of the unit and cladding type. Optionally cut sill support bar short by 100mm max each end (200mm total).

Fig.1

The reduction in sill support bar width is optional but can be used to ensure the bar misses corner soakers and provides load bearing on the drainage tray/support block

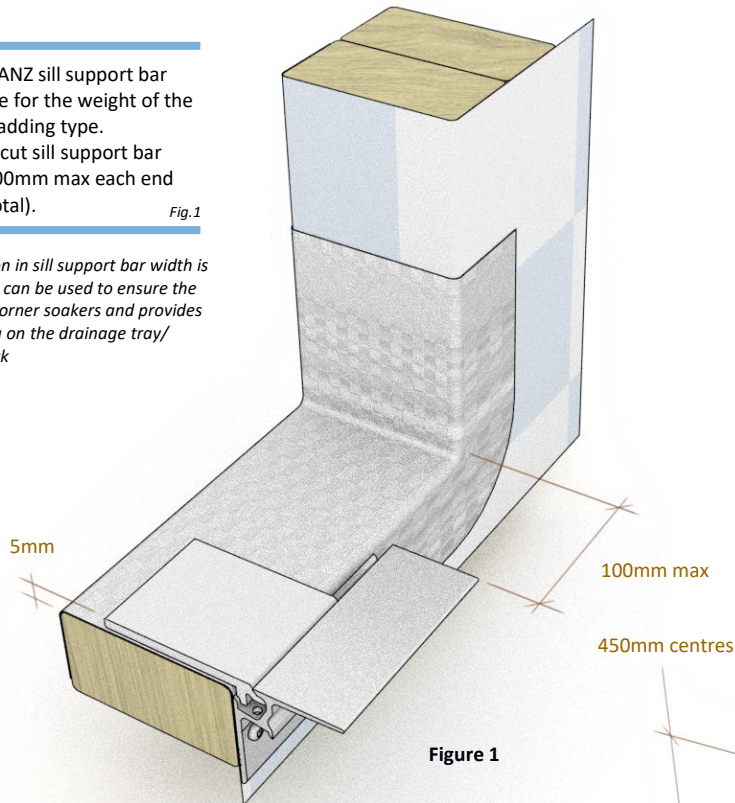

Figure 1

3

Centre support blocks in the window/door frames should be under the glazing blocks.

Support blocks are critical to ensure the window load is transferred correctly onto the support bar – this will prevent the unit sagging and creating failure points in the joinery.

4

Fixings to be min 2 x 75mm jolt head nail or 8g x 65mm SS screw

- 150mm from corners
- 450mm centres thereafter

Each fixing point to be packed

Fig.2

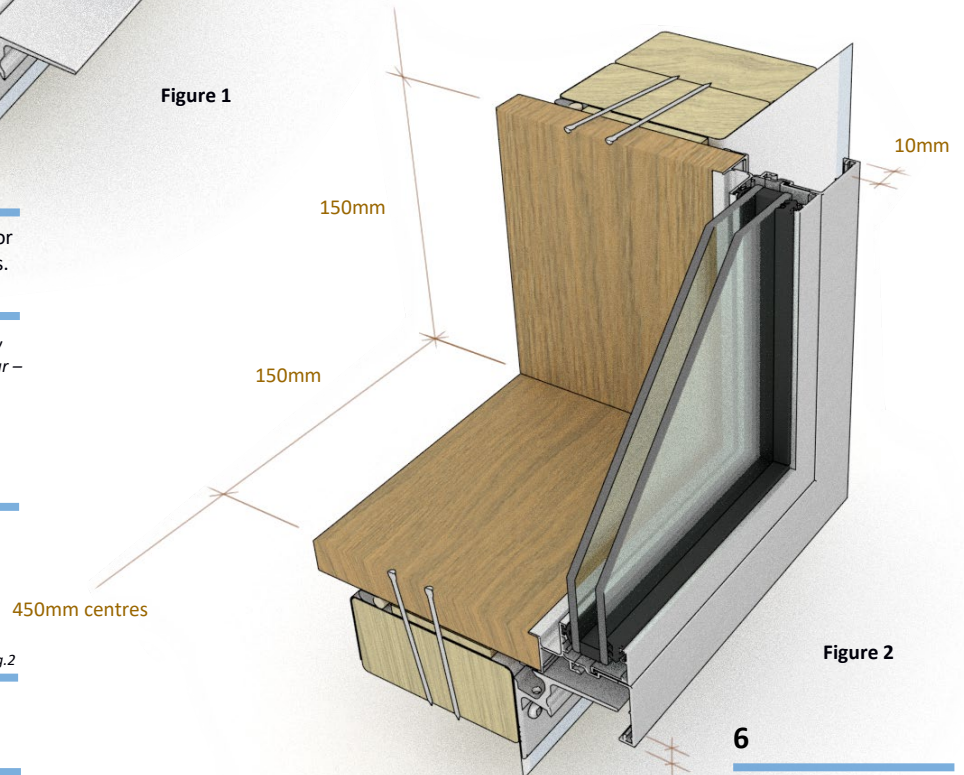

Figure 2

5

Flange is to finish against the cladding in cavity construction.

- In flat fibre cement and ply claddings allow 5mm stand-off for sealant

2

Use WANZ Location Brackets to ensure the upper edge of the support bar sits a minimum of 5mm above the sill trimmer – ensure the sill trimmer is straight and true.

The bar must be fitted so that it will not trap water on the sill trimmer.

Ensure the support bar is level by fixing the high end first and adjusting the other end.

- 10g x 50mm SS fixings
- Maximum 300mm fixing centres

Fig.1

The locator blocks are designed to be re-used but can be left in place

7

When installed the flange must have a 10mm minimum overlap to the cladding at the jamb

Fig.2

There should be no sill flashing or tray in a cavity construction installation. Head flashings are to be fitted with end caps sealed to the flashing.

6

At the sill the flange must have an 8mm minimum overlap to the cladding.

Fig.2